

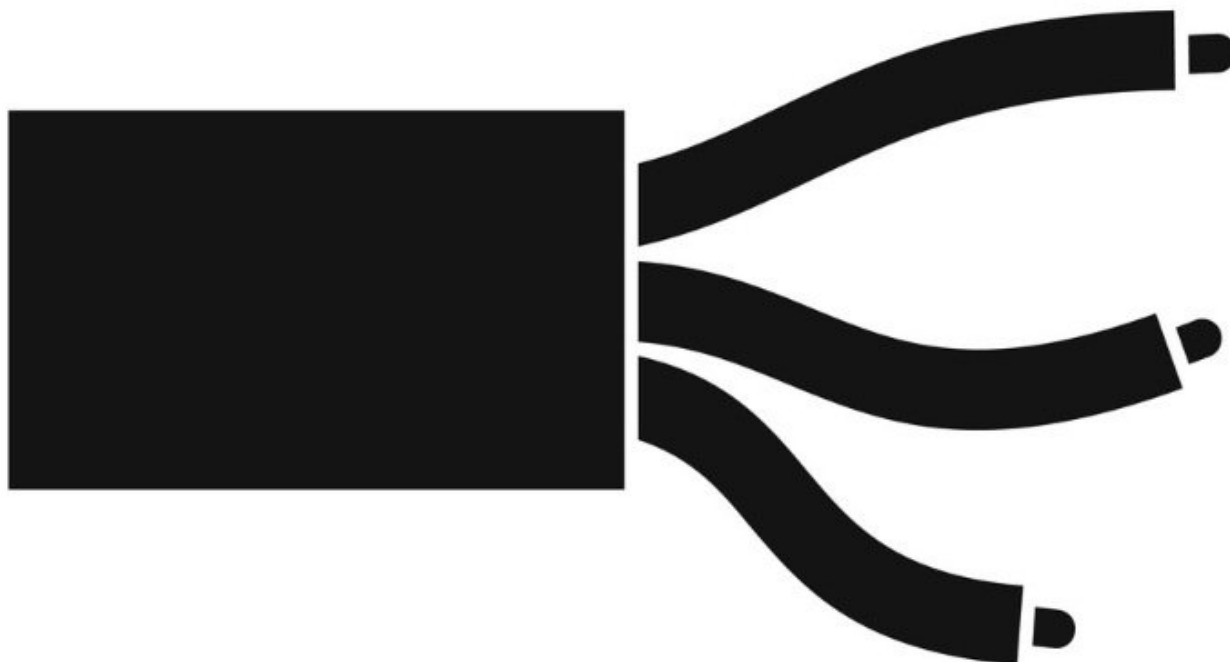

Wire to external device

Written By: Tanya Taylor



INTRODUCTION

If desired, you can connect the SM50 to an external, mains-powered device, such as an alarm, siren, extractor fan or ozone generator. To do this, you need to include a separate mains rated relay.

The set point of the on-board relay activates the relay switch, which controls your external device.

The onboard relay output is 24V; 5A (max).

Note: Mains equipment should only be wired by a certified electrician.



PARTS:

- [SM50 sensor board 0-0.15ppm](#) (1)
 - [SM50 sensor board 0-0.5ppm](#) (1)
 - [SM50 sensor board 0-10 ppm](#) (1)
-

Step 1 — Wire external device

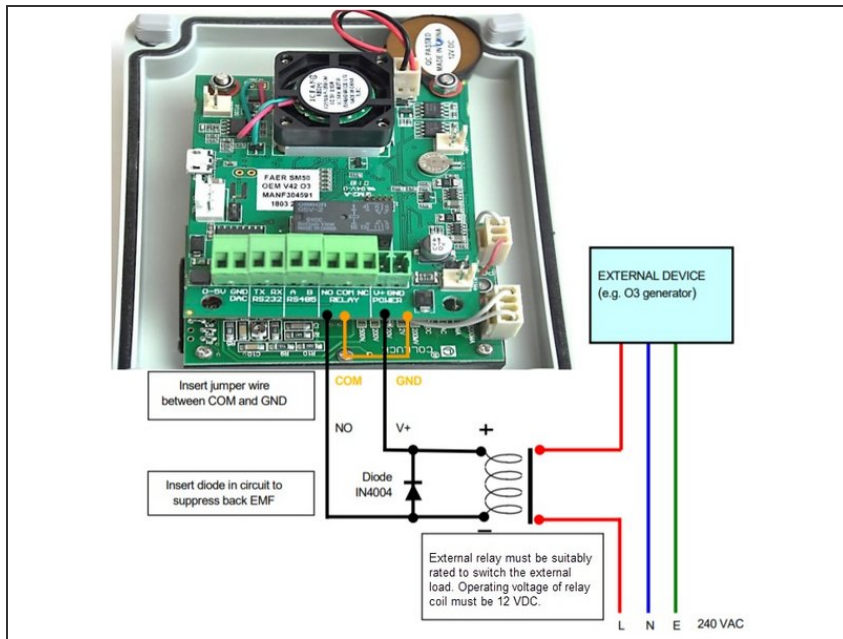

- Turn the sensor board over so you can see the underside components.
- Using the screw terminal connectors on the sensor board, wire the desired external device to either the normally open or normally closed contacts as required for your application and [firmware version](#).
- This diagram shows one method of connecting a SM50 to a mains-powered device.

For further support, contact [Technical Support](#).